



Hold your special event at Crystal Mountain! The Cascade Mountains, including neighboring Mount Rainier, serve as your breathtaking backdrop. Crystal Mountain is an easy scenic drive just 75 miles from Seattle and 60 miles from Tacoma. With on-mountain lodging, in-house catering and a multitude of free-time activities, you'll have the recipe for a successful special event for up to 600 guests.

Chinook Level in the Base Lodge

Includes basic banquet chairs and tables.

Max Occupancy w/o tables/with	Event Space (8 hr max)
375/280	\$ 1,250

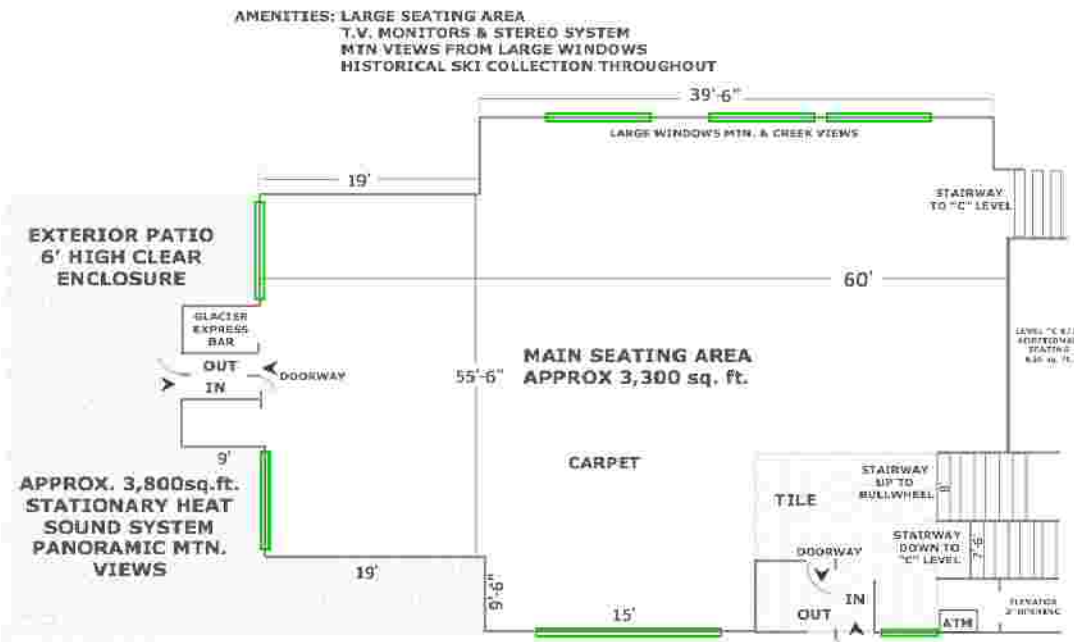

Rates subject to change

Bullwheel in the Base Lodge

Includes wooden chairs, rectangle tables and large bar.

Max Occupancy w/o tables/with	Event Space (8 hr max)
200/175	\$ 1,000

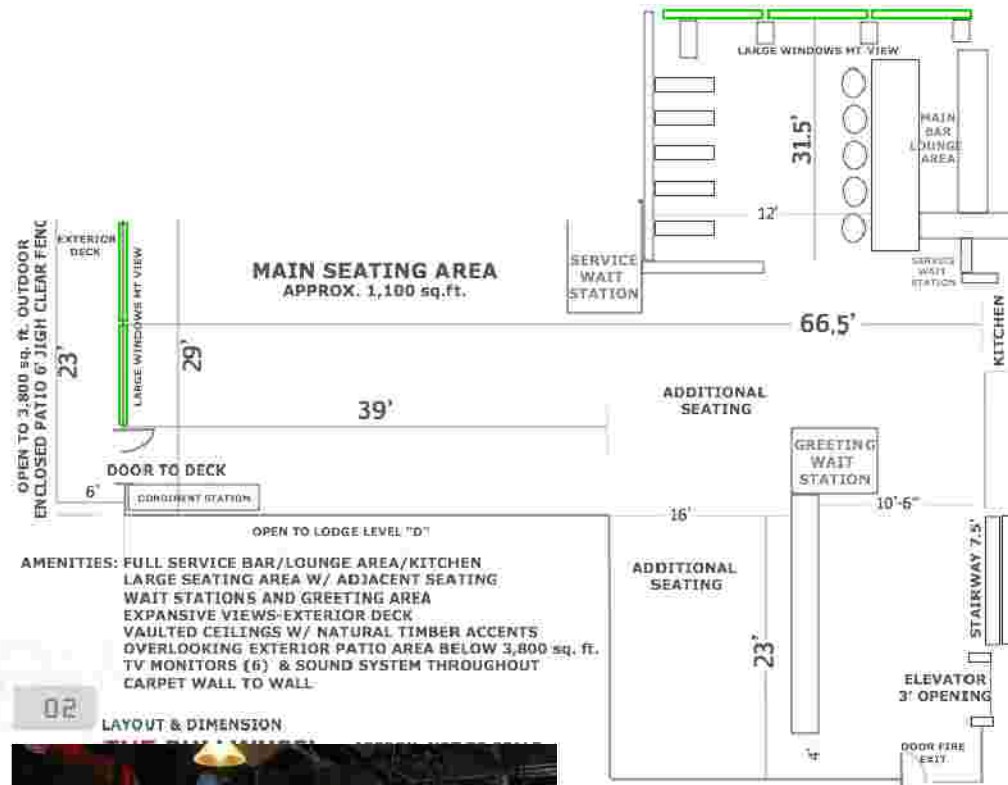

02 LAYOUT & DIMENSION



Rates subject to change

Slopeside Plaza (New for 2012) at the Base

Pictures shown are of the Sundeck (similar space and views). Includes green picnic tables or basic banquet tables and chairs (based on availability). Plaza will be 80' x 65'.

Max Occupancy w/o tables/with	Event Space (8 hr max)
600/350	\$1,000

(Located to the bottom left of the Master Stairs)

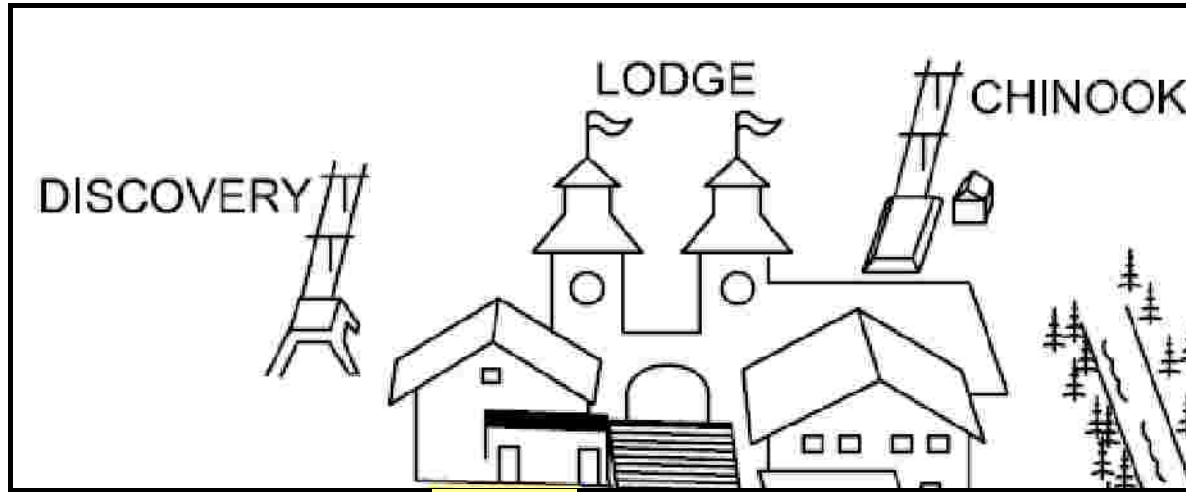

**New
Plaza**

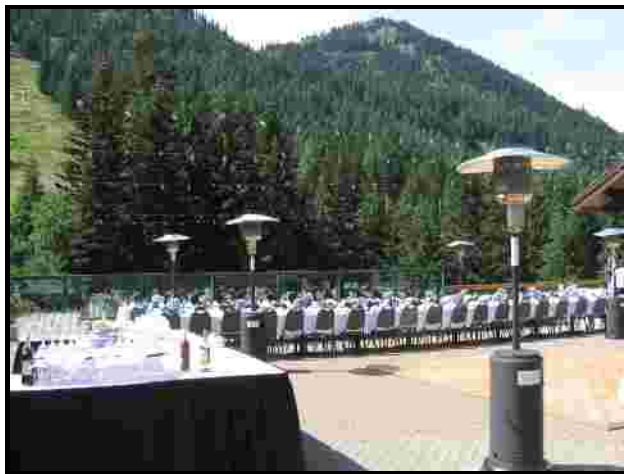

Rates subject to change

Summit House Restaurant

Includes chairs & tables from lower right photo. Removal of furniture or addition of furniture is not allowed.

Summit House Max Occupancy (24- Four-top tables)	Summit House Private Event Space Only (6 hr max, must be over by 10 p.m.)	Summit House Dinner, Lunch or Brunch Group Reservation
30- 96	\$ 1500*	See rates online Reservations: 360.663.3085



AMENITIES: THE MOST UNIQUE SETTING-WASHINGTON'S HIGHEST RESTAURANT
 LARGE SEATING AREA - WAIT STATIONS AND GREETING AREA
 EXPANSIVE VIEWS - MT. RAINIER PANORAMIC/ONE OF A KIND
 VAULTED CEILINGS W/ NATURAL TIMBER ACCENTS & KNOTTY PINE FINISH
 SOUND SYSTEM-CARPET WALL TO WALL
 FULL SERVICE KITCHEN-BEER&WINE SELECTION

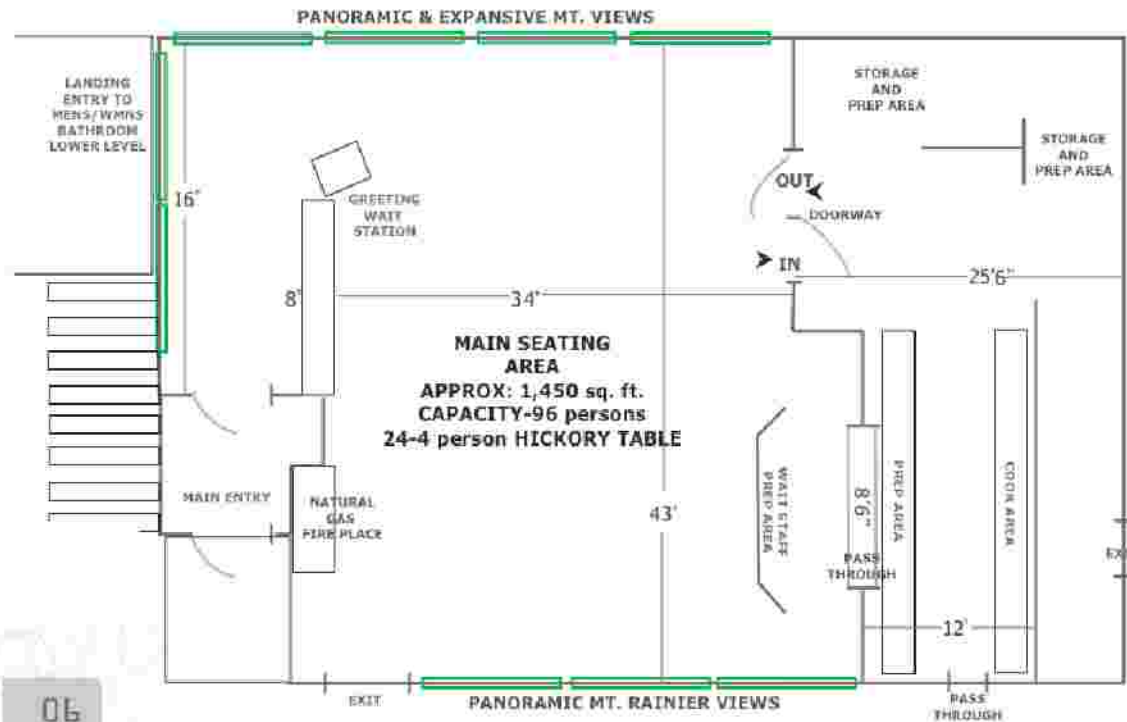

06

LAYOUT & DIMENSION

SUMMIT HOUSE RESTAURANT

APPROX: NOT TO SCALE

Rates subject to change

06

Chapel/Multi-Use Building at the Base

Includes setup of basic banquet chairs (conference-style). Banquet tables may be rented.

Max Occupancy w/o tables/with	Event Space Only (8 hr max)
150/ N/A	\$500

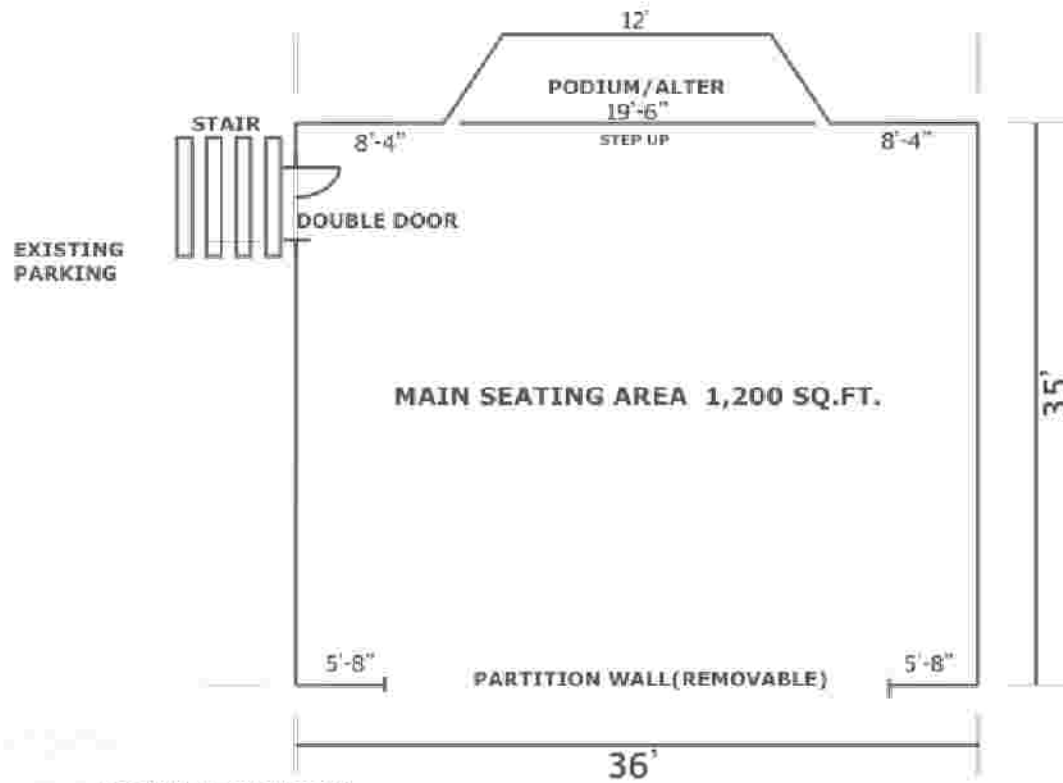

LAYOUT & DIMENSION
THE CHAPEL

OPEN TO 1,000 sq. ft.
ADDITIONAL SPACE



Rates subject to change

Cascade & Heritage Level in the Base Lodge

Includes setup of basic banquet chairs and tables.

Cascade Max Occupancy w/o tables/with	Heritage Max Occupancy w/o tables/with	Cascade Event Space Only (8 hr max)	Heritage Event Space Only (8 hr max)
125/ 75	60/ 40	\$750	\$500

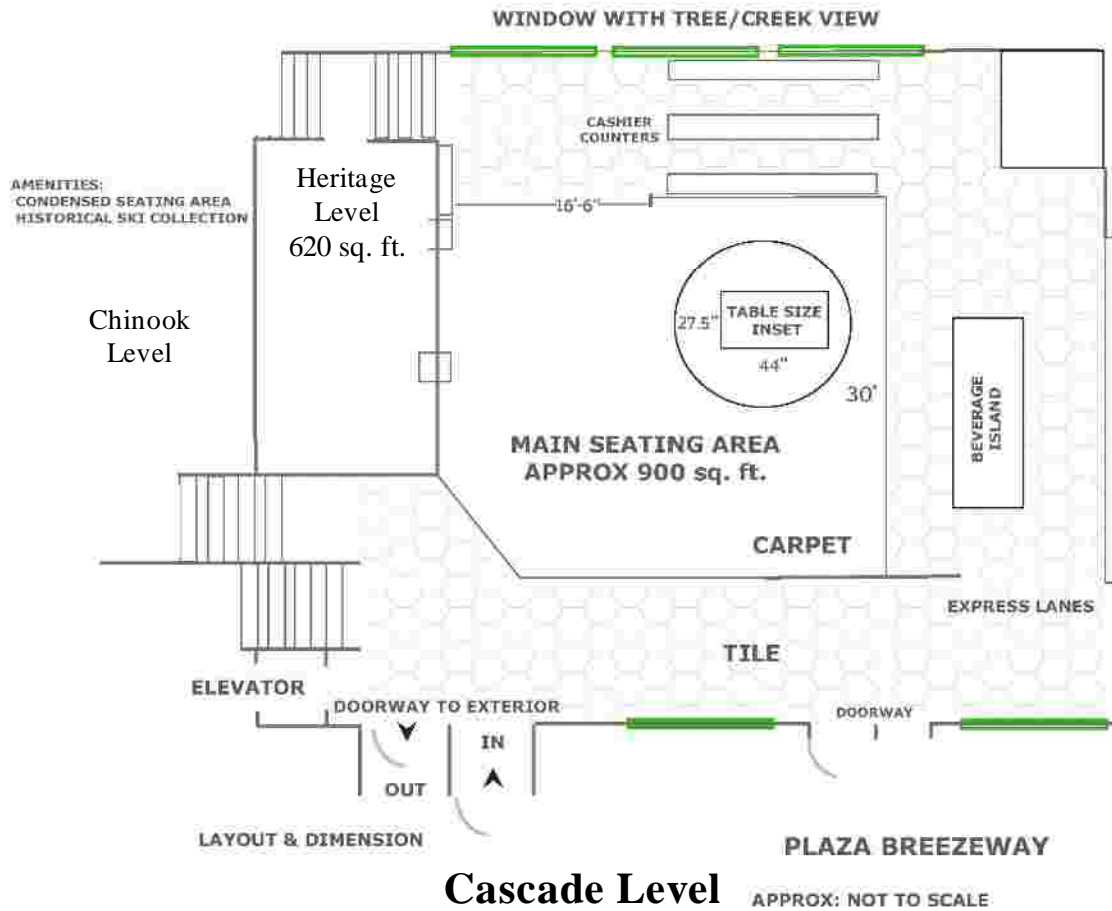

Rates subject to change

Brownbag Level in the Base Lodge

Includes setup of chairs and banquet tables.

Max Occupancy w/o tables/with	Event Space Only (8 hr max)
120/ N/A	\$250

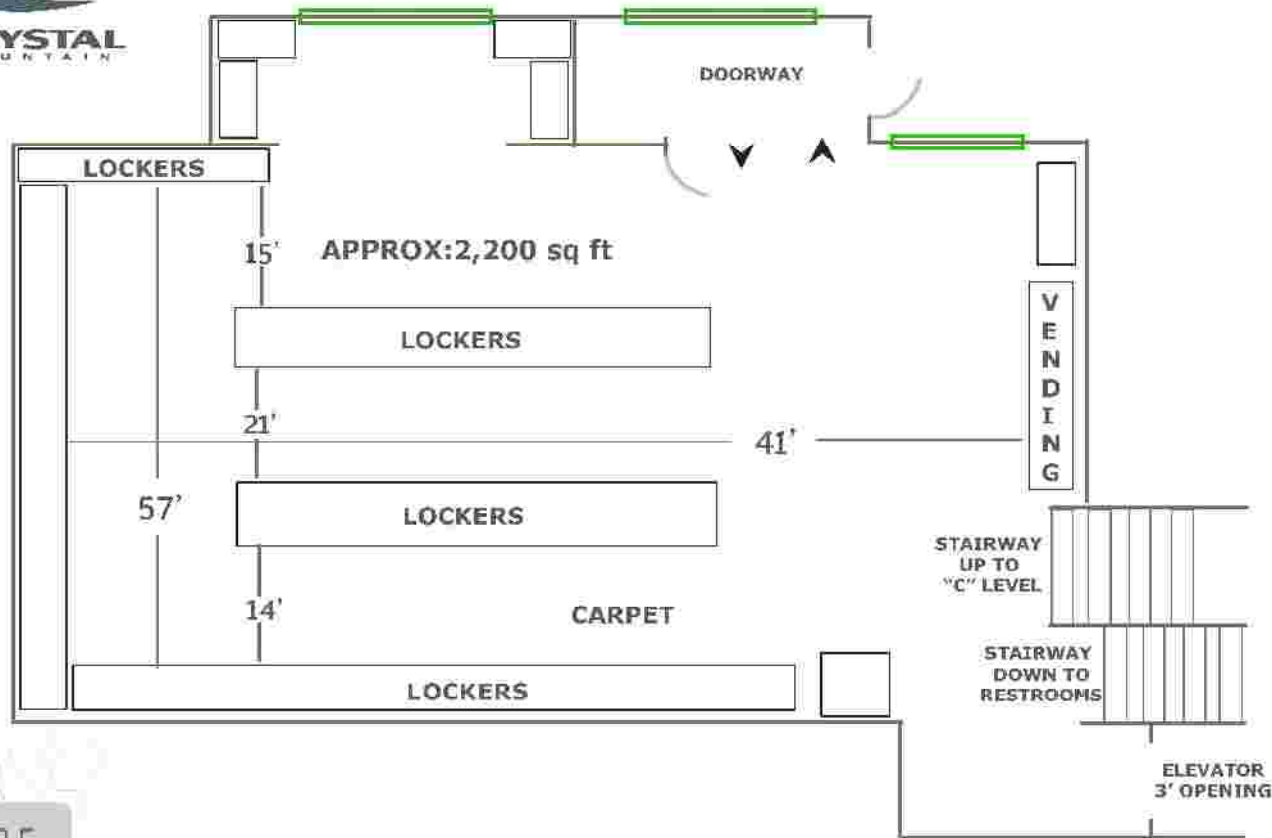

LAYOUT & DIMENSION
THE LODGE B_LEVEL

APPROX: NOT TO SCALE

2012 Additional Information

Deposits and Payment Policies: A non-refundable 50% venue fee deposit is required to reserve rental site upon booking and the remainder will be due 30 days prior to your event along with a non-refundable 50% deposit of the anticipated catering charges. If payment is not received, your event may be subject to cancellation. The remaining balance is due at the conclusion of the event. Late payments will be assessed a \$25 charge per day.

Event Site Rates: Venue rates include exclusive use of the contracted venue and Banquet Manager to help assist in venue and catering planning needs within the resort. Venue fees for events includes basic set-up & break-down, tables, basic white table linens and napkins, indoor chairs (each venue has unique chairs), standard glassware, dinnerware and silverware. Venue fee for conference site includes basic set-up & break-down of banquet chairs (base area only). Slopeside plaza venue includes round green picnic furniture or tables and chairs (depending on availability).

Menus & Catering: Crystal Mountain Catering welcomes the opportunity to create special menus that are chosen from our printed suggestions. We require a finalized menu a minimum of 3 weeks prior to your special event. The special event cake will be the only food that is allowed in from an outside caterer. There may be a cake-cutting fee per person attending the wedding. Additional fees for full-service will apply.

Crystal Mountain In- House Catering (Food and Beverage) Minimums*:

June & September	May & October	July & August
Saturday: \$3,500.00 minimum	Saturday: \$2,500 minimum	Saturday: \$4,500 minimum
Friday & Sunday: \$3,000.00 minimum	Friday & Sunday: \$2,000 minimum	Friday & Sunday: \$3,000 minimum
Monday-Thursday: \$2,000.00 minimum	Monday- Thursday: \$1,000 minimum	Monday –Thursday: \$2,000.00 minimum

*Food & Beverage minimums may vary at the Summit House. Please inquire.

*All prices are subject to a 18% service charge (20% for plated) and 7.8% WA State Sales Tax. All pricing is subject to change until finalized per contract

Lodging: Crystal Mountain Resort does not own or operate any of the lodging facilities at the resort. Please visit www.staycrystal.com for information on room types, pricing, group discounts, room blocks and availability for two on-mountain facilities and one nearby resort. There are also other nearby lodging options, please visit "Vacation Rentals" under "Plan your Trip" at www.crystallmountainresort.com

The Crystal Mountain Lodging Suites, located at Crystal Mountain, offers condominiums (sleeps 2-8 people), a heated swimming pool, and is conveniently located within a couple minute walk to the base area. Contact: 1.888.ON.THE.MT

The Crystal Mountain Hotels, located at Crystal Mountain, offers standard hotel rooms (sleeps 1-6), a breakfast buffet, and is conveniently located within a couple minute walk to the base area. Contact: 1.888.754.6400

The Alta Crystal Resort, located 10 minutes from Crystal Mountain, offers suites, cabins, a honeymoon cabin, a heated swimming pool, hot tub and a fun family friendly environment. Contact: 1.800.277.6475